

**Lukas Pond
Old County Road
Windsor Locks, CT**

**ADDENDUMS
to
Town and State
Wetlands & Watercourses Applications**

PREPARED BY

**ED LALLY AND ASSOCIATES, INC.
111 PROSPECT HILL ROAD
WINDSOR, CONNECTICUT**

March 2026

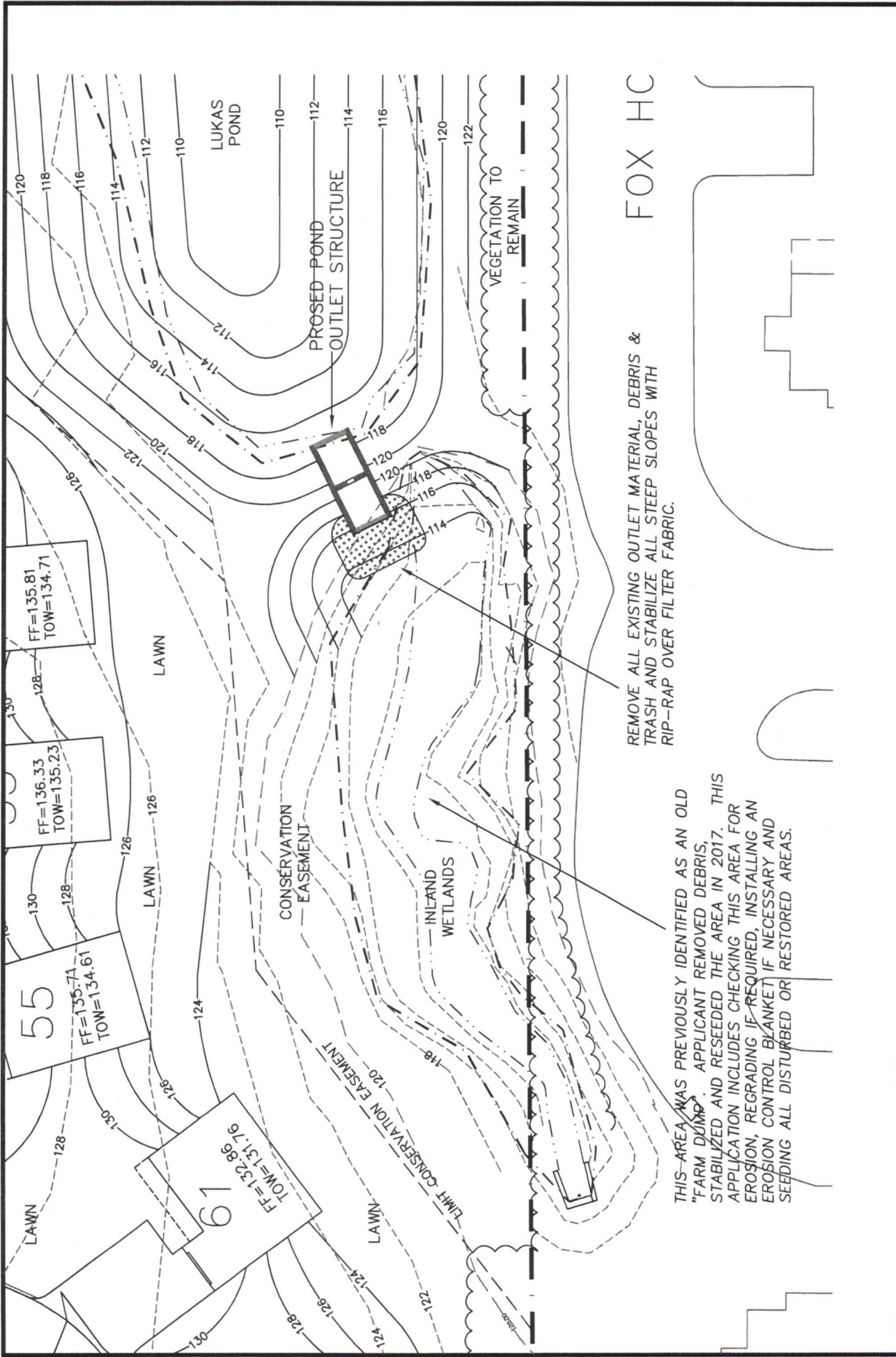

REMOVE ALL EXISTING OUTLET MATERIAL, DEBRIS & TRASH AND STABILIZE ALL STEEP SLOPES WITH RIP-RAP OVER FILTER FABRIC.

THIS AREA WAS PREVIOUSLY IDENTIFIED AS AN OLD "FARM DUMP". APPLICANT REMOVED DEBRIS, STABILIZED AND RESEDED THE AREA IN 2017. THIS APPLICATION INCLUDES CHECKING THIS AREA FOR EROSION, REGRADING IF REQUIRED, INSTALLING AN EROSION CONTROL BLANKET IF NECESSARY AND SEEDING ALL DISTURBED OR RESTORED AREAS.

FOX HC

VEGETATION TO REMAIN

REVISION TO POND OUTLET STRUCTURE, LOCATION & GRADING

LUKAS POND
ADDENDUM # 1

SCALE: 1 IN = 30 FT

MARCH 3, 2026

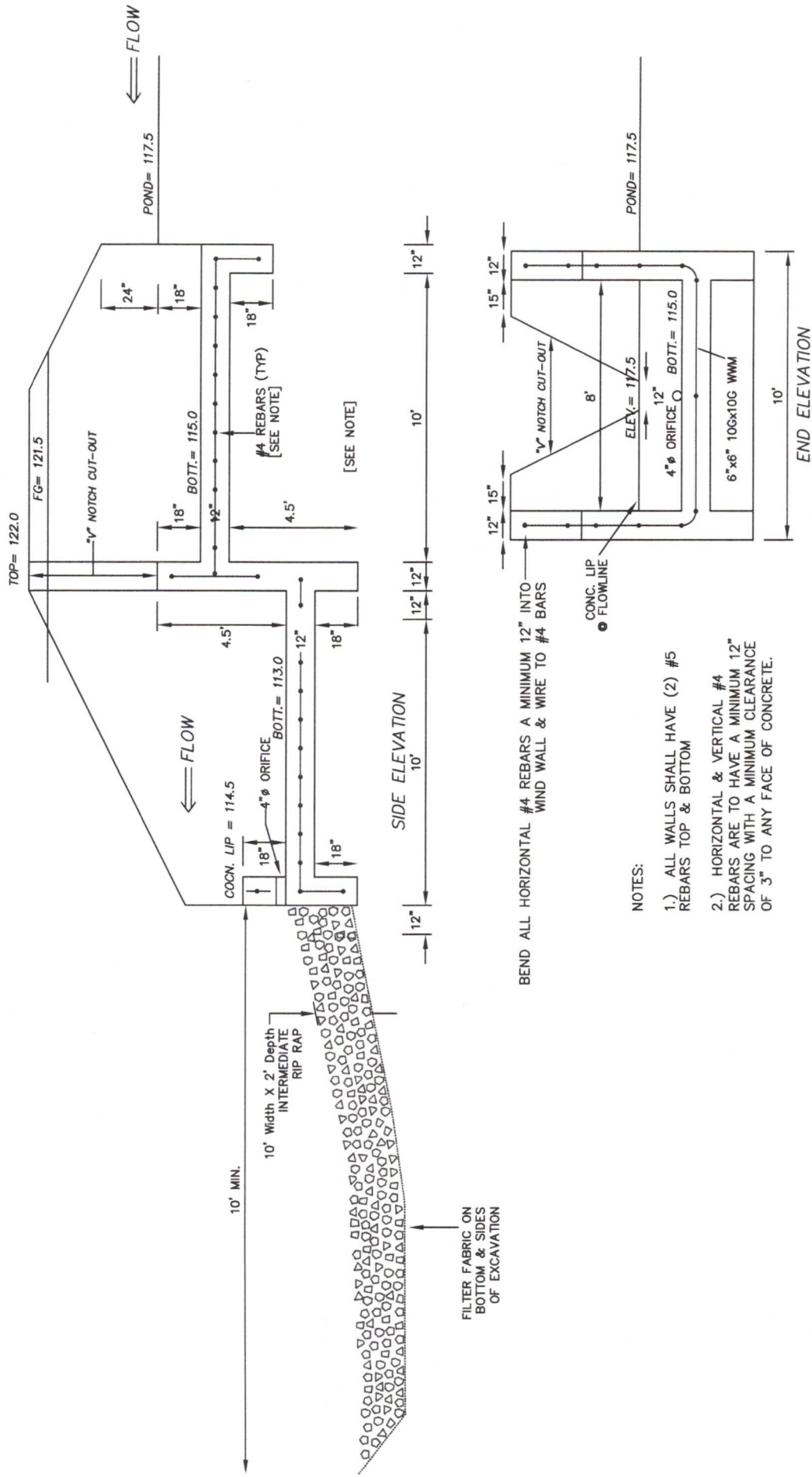

LUKAS POND
ADDENDUM # 2

POND OUTLET STRUCTURE
DETAIL

SCALE: NONE

MARCH 3, 2026

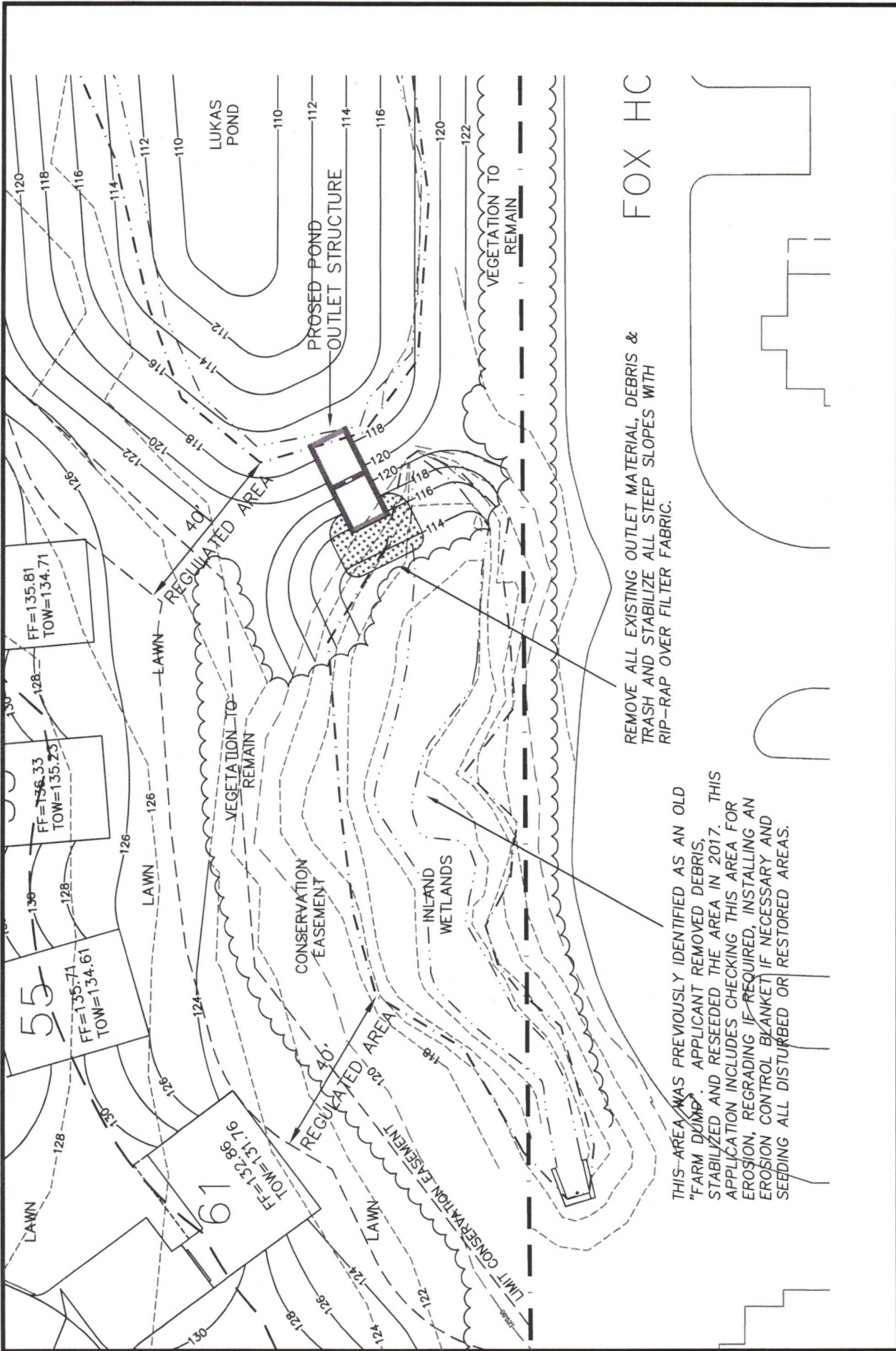

REMOVE ALL EXISTING OUTLET MATERIAL, DEBRIS & TRASH AND STABILIZE ALL STEEP SLOPES WITH RIP-RAP OVER FILTER FABRIC.

THIS AREA WAS PREVIOUSLY IDENTIFIED AS AN OLD "FARM DUMP". APPLICANT REMOVED DEBRIS, STABILIZED AND RESEDED THE AREA IN 2017. THIS APPLICATION INCLUDES CHECKING THIS AREA FOR EROSION, REGRADING IF REQUIRED, INSTALLING AN EROSION CONTROL BLANKET IF NECESSARY AND SEEDING ALL DISTURBED OR RESTORED AREAS.

LUKAS POND ADDENDUM # 3

REVISION TO ADDENDUM #1 POND OUTLET, STRUCTURE, LOCATION & GRADING

SCALE: 1 IN = 30 FT

MARCH 10, 2026

Addendum # 1 - REVISION TO POND OUTLET (revised the location, elevation, grading and rip-rap of the pond outlet structure at the reconstructed man-made pond) and:

Addendum # 2 - POND OUTLET STRUCTURE DETAILS (revised the dimensions, elevations and details of the outlet structure) and;

Addendum # 3 - REVISION TO ADDENDUM #1 resulted in a reduction in the areas of impact to the watercourse, the adjacent wetlands and the upland review areas, necessitating changes in the STATEWIDE INLAND WETLANDS & WATERCOURSES AVTIVITY REPORTING FORM and the Calculation of Wetlands Fee.

These revised documents are attached and comprise this ADDENDUM # 4

LUKAS POND
ADDENDUM # 4

Description:

Reduction in Wetlands Impact

Date: March 10, 2026

LUKAS POND

Old County Road

Corrected Wetlands Fee

List of Disturbances

Location	Area
Wetlands and 80' Upland Review Area at western brook	
Impact to	
Watercourse	96 sf
Adjacent Wetlands	594 sf
40' & 80' Regulated Area	9,486 sf
Total Impact this Location	10,176 sf
Wetlands and 40' 80' Upland Review Area at Road Crossing and Pc	
Impact to	
Watercourse	928 sf
Wetlands including Silted in Man-made Pond	25,352 sf
40' & 80' Regulated Area	64,008 sf
Total Impact this Location	90,288 sf
Total Impact this project	100,464 sf

Impacts to the Rip-rap channelized brook, the Silted in man-made Pond and the Brook and Wetlands downstream of Pond were previously made, however, these areas will be impacted with this proposal to reconstruct the pond and its outlet and to stabilize the area.

	Area	Fee
Base Fee	\$150	\$150
Schedule A Fee		
Disturbance of a Regulated Area including Regulated Uplands		
First 1,000 sf of disturbance	\$75/1000 sf 1,000	\$75
Disturbance over 1,000 sf up to 5,000 sf	\$20/1000 sf 4,000	\$80
Disturbance over 5,000 sf	\$14/1000 sf 95,464	\$1,336
State Fee is \$60	\$60	\$60
Total Wetlands Fee		\$1,701



Statewide Inland Wetlands & Watercourses Activity Reporting Form

Please complete and mail this form in accordance with the instructions.
If completing by hand - please print and use the [pdf version](#).
Incomplete or incomprehensible forms will be mailed back to the municipal inland wetlands agency.

PART I: Must Be Completed By The Inland Wetlands Agency

- DATE ACTION WAS TAKEN: year: [Click Here for Year](#) month: [Click Here for Month](#)
- CHOOSE ACTION TAKEN (see instructions for code): [Click Here to Choose a Code](#)
- WAS A PUBLIC HEARING HELD (check one)? yes no
- NAME OF AGENCY OFFICIAL VERIFYING AND COMPLETING THIS FORM:
(type name) _____ (signature) _____

PART II: To Be Completed By The Inland Wetlands Agency Or The Applicant

- TOWN IN WHICH THE ACTIVITY IS OCCURRING (type name): [Windsor Locks](#)
does this project cross municipal boundaries (check one)? yes no
if yes, list the other town(s) in which the activity is occurring (type name(s)): _____, _____
- LOCATION (click on hyperlinks for information): [USGS quad map name: Windsor Locks](#) or [quad number: _____](#)
[subregional drainage basin number: 4300-53](#)
- NAME OF APPLICANT, VIOLATOR OR PETITIONER (type name): [LLP, LLC](#)
- NAME & ADDRESS OF ACTIVITY / PROJECT SITE (type information): [177 OLD COUNTY ROAD](#)
briefly describe the action/project/activity (check and type information): temporary permanent description: [Private road & storm system for 41 homes meeting 2024 Connecticut Stormwater Quality Manual & DEEP erosion controls.](#)
- ACTIVITY PURPOSE CODE (see instructions for code): [B](#)
- ACTIVITY TYPE CODE(S) (see instructions for codes): [1, 2, 10, 12](#)
- WETLAND / WATERCOURSE AREA ALTERED (see instructions for explanation, type acres or linear feet as indicated):
wetlands: [0.60](#) acres open water body: _____ acres stream: [-256th.00](#) linear feet
- UPLAND AREA ALTERED (type acres as indicated): [1.69](#) acres
- AREA OF WETLANDS / WATERCOURSES RESTORED, ENHANCED OR CREATED (type acres as indicated): [1.02](#) acres

DATE RECEIVED:

PART III: To Be Completed By The DEEP

DATE RETURNED TO DEEP:

FORM COMPLETED: YES NO

FORM CORRECTED / COMPLETED: YES NO