

BUFFER AREA DISTURBANCE
= 41,035 Sq. Ft.

BUFFER AREA DISTURBANCE
= 15,720 Sq. Ft.

BUFFER AREA DISTURBANCE
= 6,350 Sq. Ft.

POND RESTORATION = 17,300 Sq. Ft.
ROAD CROSSING = 3,965 Sq. Ft.
DRAINAGE IMPROVEMENTS = 3,440 Sq. Ft.

TOTAL WETLAND DISTURBANCE = 24,705 Sq. Ft.

TOTAL BUFFER DISTURBANCE = 63,105 Sq. Ft.

TOTAL WETLAND DISTURBANCE = 24,705 Sq. Ft.

PROPOSED DISTURBANCES

LUKAS POND - MFSD SITE PLAN & SPECIAL USE
PREPARED FOR
F & L CONSTRUCTION LIMITED
177 OLD COUNTY ROAD
WINDSOR LOCKS, CONNECTICUT

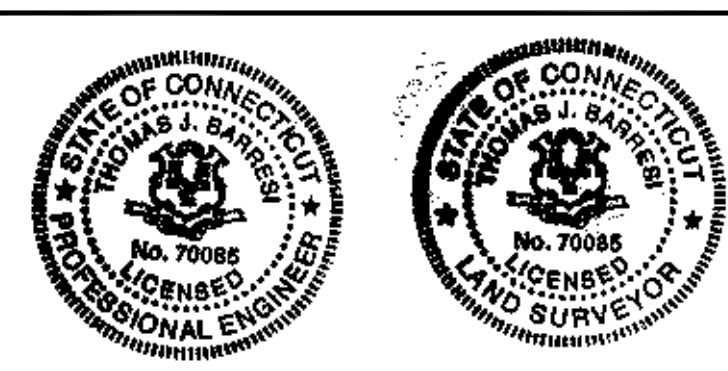

TO MY KNOWLEDGE AND BELIEF, THIS MAP IS
SUBSTANTIALLY CORRECT AS NOTED HEREON

BARRESI
ASSOCIATES LLC

1695 POQUONOCK AVENUE - WINDSOR, CONN. 06095
(860) 219-9260 www.barresillc.com

DATE	REVISION