

**POLICY OF THE
STOCKBRIDGE CEMETERY COMMISSION
P.O. BOX 39, STOCKBRIDGE, VERMONT 05772
802-746-8400**

Introduction

The Stockbridge Cemetery Commission (SCC) is a committee, composed of three commissioners, who are elected to serve a staggered three-year term. Our meetings are announced on the Town's website: <https://stockbridgevt.gov>. and open to the public. All burial records are open to the public and can be viewed at the Town Office. The SCC policy is aligned with Vermont State Statutes. Please direct all concerns regarding the Cemeteries to the SCC

The Cemeteries under the care of the SCC in the Town of Stockbridge, Vermont

Abbott, Bartlett, Maplewood,
Mount Pleasant, South Hill, Stratton, and Sylvester

Cemetery Guidelines

Our Cemeteries are always open to visitors. Burials can take place from dawn until dusk between May 1 and November 30, weather permitting. Burials between December 1 and April 30 will be considered by the SCC under special circumstances, weather permitting. Care of the cemeteries is assumed by the SCC. It includes cutting of the grass and general maintenance.

Persons who are eligible to be buried in a Stockbridge cemetery

- A present cemetery lot owner
- A person who has been willed a lot by its owner
- A lot owner may leave the lot to the cemetery, in trust, for the use and benefit of any person designated in the will. If the lot is not mentioned in the will it will pass to the heirs, as if the owner had died without a will. 18 V.S.A. § 5531(a).
- A spouse of the person to whom a lot is willed
- A year-round resident of Stockbridge, VT
- A long-time resident who has spent years in out-of-town care
- A person who has a long-standing personal association with Stockbridge, VT
- All other requests will be considered by the SCC.

The Vermont State Department of Human Services and associated agencies may provide some financial assistance to help cover burial expenses for a person, who dies in Vermont, and is receiving public assistance under Title IV or XVI of the Social Security Act, or nursing home care under Title XIX of the Social Security Act, or assistance under state aid to the aged, blind or disabled, or an honorably discharged veteran of any branch of the U.S. military.

Purchasing cemetery lots

- Cemetery lots generally measure 4' x 10' with some variation by cemetery. Each grave can accommodate one full burial of 1 casket, or 1 shroud, up to 4 urns or flat memorial markers.
- Lots are sold at the discretion of the SCC and in sequential order.
- Upon receipt of payment, a lot location will be assigned.
- Each lot or group of lots requires marking by four 6" x 6" x 6" blank granite cornerstones.
- If multiple adjacent lots are purchased as a group, only one set of cornerstones are required for the group.
- If the buyer has personalized cornerstones installed within one year of the lot purchase date and returns the original cornerstones, the price of the original cornerstones will be refunded.
- Cornerstones are to be installed only by the Sexton. Lot owners are not permitted to install their own cornerstones.
- Lots may not be resold but can be returned to the Town for a refund of the original purchase price.

Cost Summary and Sample Lot Illustration

Price Per Lot	Four Cornerstones	Cornerstone Installation	Total Cost Per Lot
\$350	\$132	\$100	\$582

SAMPLE LOT DETAIL

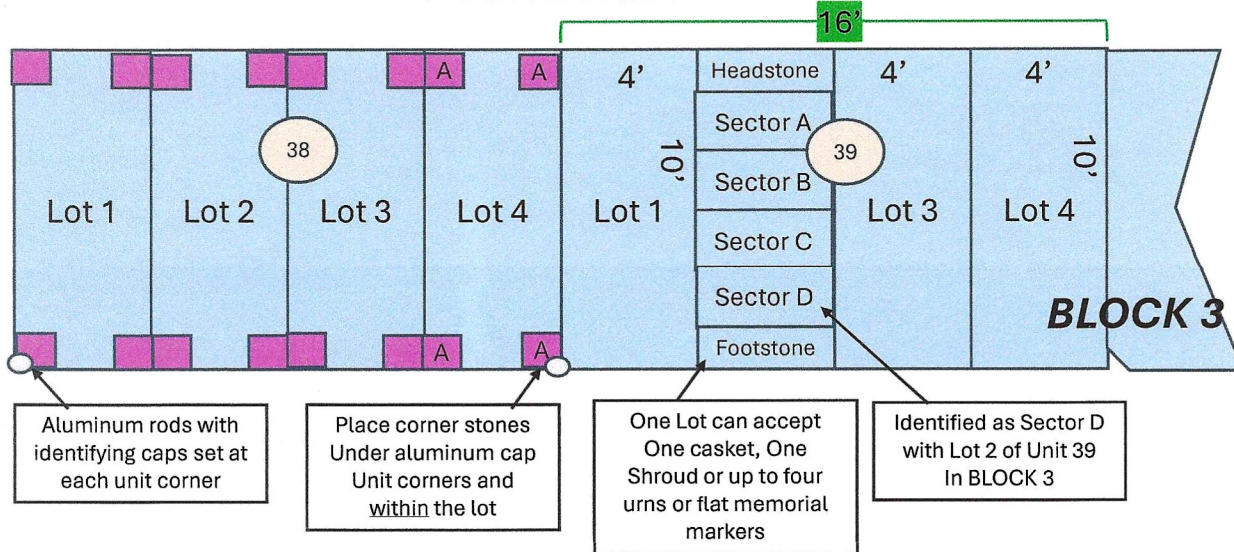

**Unless otherwise approved by the SCC
the following regulations must be observed**

- Lots are solely for the burial of human remains or cremated human remains. Pet or animal burials are not allowed.
- If a burial vault is used the grave must be deep enough to allow for sufficient topsoil to completely cover the vault.
- Burial of remains in a casket or shroud must be at least 3 1/2' deep, measured from the natural surface of the ground to the bottom of the outside casket or biodegradable platform.
- Excavation of a burial site must be arranged with the Sexton who is also responsible for finishing grading, replacing sod and grass seeding.
- The removal of human remains for burial within the same cemetery, within or outside of Vermont, requires a removal permit issued by the Town Clerk pursuant to 18 V.S.A. § 5212.
- Vaults or cement grave liners are required for all burials except cremations or natural burials.
- Natural burials will be permitted at Maplewood and South Hill cemeteries upon approval of the SCC and must follow natural burial best practices. See the SCC Natural Burial policy for details.
- Prior to installation of a memorial headstone, the installer of the headstone must verify the lot location and the stone's orientation for proper installation as referenced on the Internment Order with the Town Clerk.
- A memorial must be installed within one year of date of burial on all occupied lots, with a minimum engraving of first and last name, date of birth and death of the deceased.
- Lots may not be enclosed with fences, curbing, or hedges.
- Planting large perennials such as bushes or trees must be approved in advance by the SCC.
- Expired ornamentations must be removed by the owner or family members in a timely manner, no later than April 15.
- The SCC reserves the right to remove ornamentation that is old, decayed or unsightly.

Stockbridge Cemetery Commission

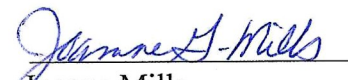
Joanne Mills

Nancy McCullough

Sharon Pavlik

Effective November 18, 2025

Stockbridge Cemetery Commission Natural Burial Policy Addendum

Introduction

The Stockbridge Cemetery Commission (SCC) has designated Maplewood and South Hill Cemeteries for consideration of "Natural Burials". Anyone interested in natural burials should contact the SCC in advance as some restrictions may apply.

Natural burial is a way of caring for the deceased that promotes the natural decomposition of the body with minimal impact to the environment. The deceased are buried without the use of embalming fluids, burial vaults or modern caskets and are instead buried in a simple, biodegradable casket or shroud. Natural burials may be chosen for a host of reasons, religious tradition, spiritual meaning, simplicity and environmental ethics.

SCC Natural Burial Guidelines

- Natural burials are subject to the same requirements as the overall SCC Policy.
- If you are considering a Natural Burial, it is recommended that you pre-purchase a lot and let your family and/or friends know your burial wishes.
- Natural burial lot pricing of lots and required cornerstones are the same as traditional burials.
- Only Maplewood and South Hill cemeteries will be considered by the SCC for natural burials.
- It is recommended that you identify a licensed funeral director in advance who can work with the SCC and Sexton to honor your natural burial wishes.
- Families are not required to hire a licensed funeral director in the State of Vermont. However, the SCC requires you contact the Sexton to make burial arrangements and understand your responsibilities.
- All burials require the use of the SCC Sexton. Excavation without the Sexton is not allowed.
- Natural burials require a plant-based biodegradable container. Unfinished wooden caskets, wicker/woven caskets and shrouds made of natural fibers are acceptable options.
- All caskets must arrive at the cemetery properly sealed for burial. Shrouded bodies must arrive at the cemetery entirely wrapped and supported by a solid unfinished wooden board with natural fiber straps for lowering. A board must be the approximate width and length of the body to be lowered within the 4' x 10' lot space. Plywood, particle board, or non-natural support boards are not permitted.
- Families and friends are invited to participate as much as they feel comfortable but are not permitted to dig or complete the final filling of the grave. Lowering of the body into the grave requires at least 4 to 6 people who are capable of performing this task. If not using a licensed funeral director, arrangements for participation and lowering of the remains must be made in advance with the Sexton.

Stockbridge Cemetery Commission

Joanne Mills

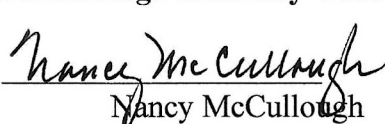
Nancy McCullough

Sharon Pavlik

Effective November 18, 2025